

HIFIT 44UX & HIFIT 400UX

HIFIT SERIES

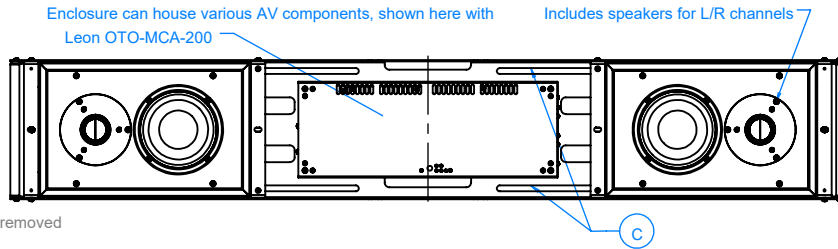

Front View with grill removed

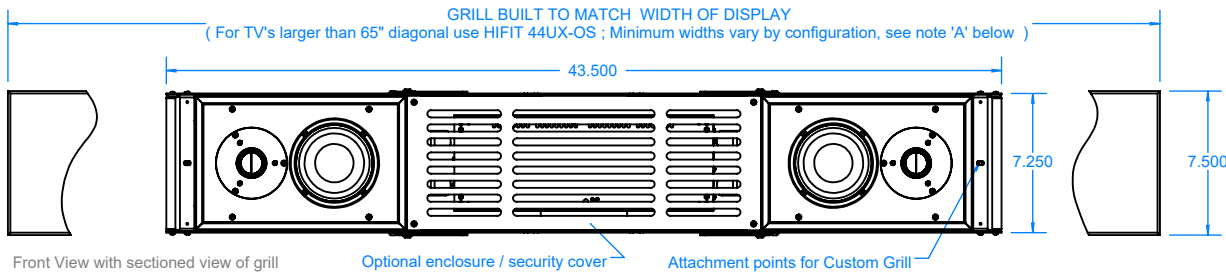
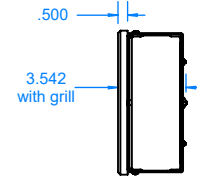

Front View with sectioned view of grill

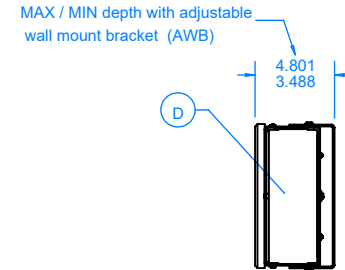

Shown with AWB

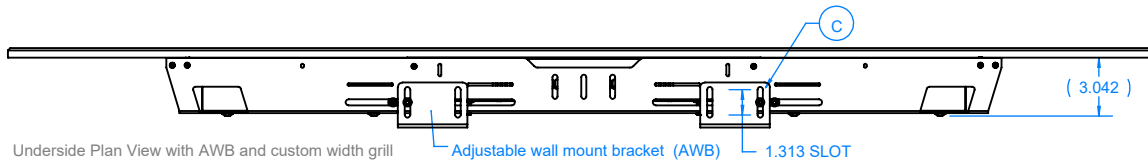

Underside Plan View with AWB and custom width grill

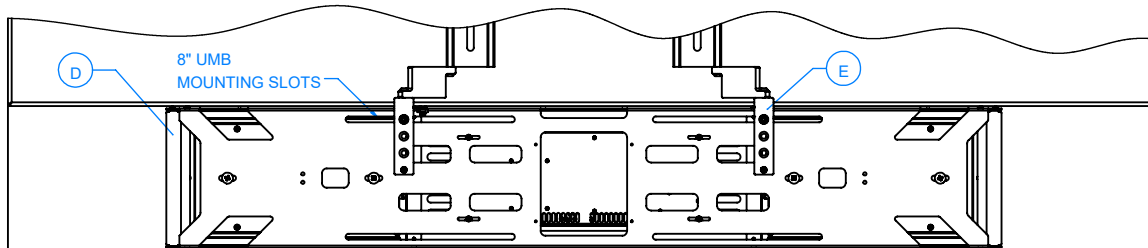

Back View with UnderMount Bracket and custom width grill

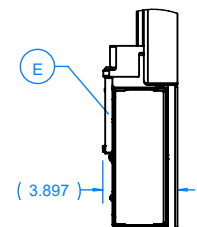

FEATURE AND CONFIGURATION NOTES:

- A. HIFIT 44UX minimum configuration width: 44.00"
- B. For TV's larger than 65" diagonal use HIFIT 44UX-OS
- C. Wall mounting options include through slots with horizontal adjustment, as well AWB with depth adjustment
- D. Hinged access door allows for tool free grill installation
- E. Under Mount Bracket (HzUMB / HzUMB-OS) attaches assembly directly to TV for articulating TV mounts

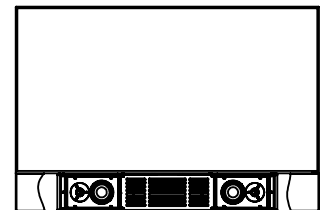

715 W. Ellsworth Rd. Ann Arbor, MI 48108
1-888-213-5015 | www.leonspeakers.com

This information is the confidential, proprietary property of Leon Speakers, Inc. Unauthorized use is prohibited. Features, specifications and appearance are subject to change without notice

A

Description	Date	Scale
HIFIT 44UX & HIFIT 400UX	1/12/2018	1:10