



PrSMB

INSTALLATION GUIDE

Picture perfect sound.®



Visit us online for product support, guides and videos
www.leonspeakers.com/support

Questions?

Call Customer Service

1.888.213.5015

Mon-Fri 8am-6pm EST

PrSMB : Profile Side Mount Bracket

Leon’s Profile Side Mount Bracket can be used to mount your Leon Profile speaker to the sides of any TV. This versatile bracket offers multiple points of adjustment for a perfect fit, every time.

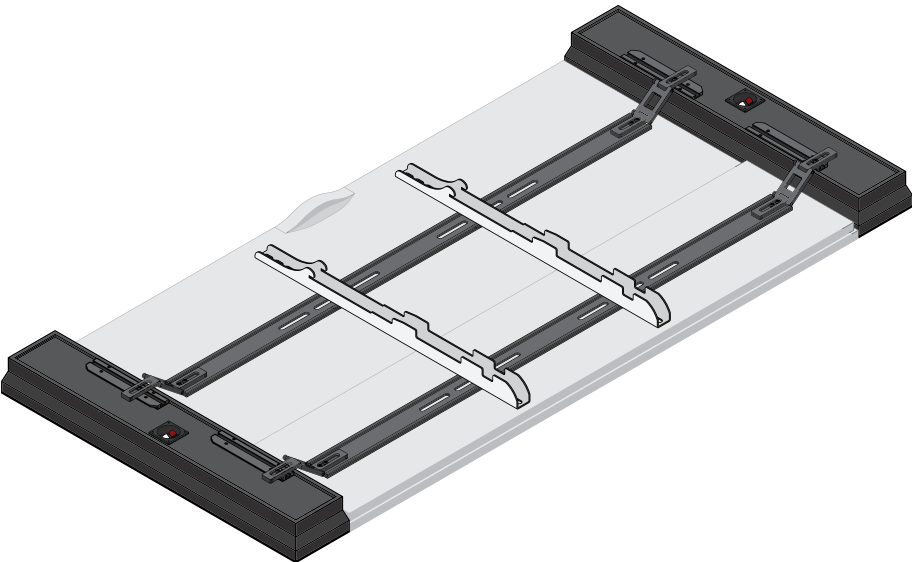

----- Completed Install -----

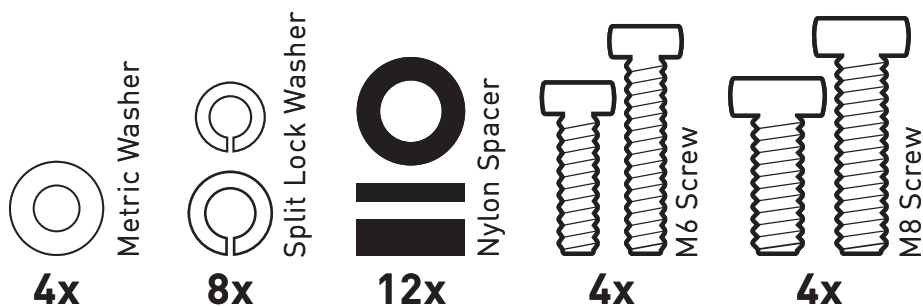

[Universal TV Mount Hardware]

*not to scale / extra hardware included

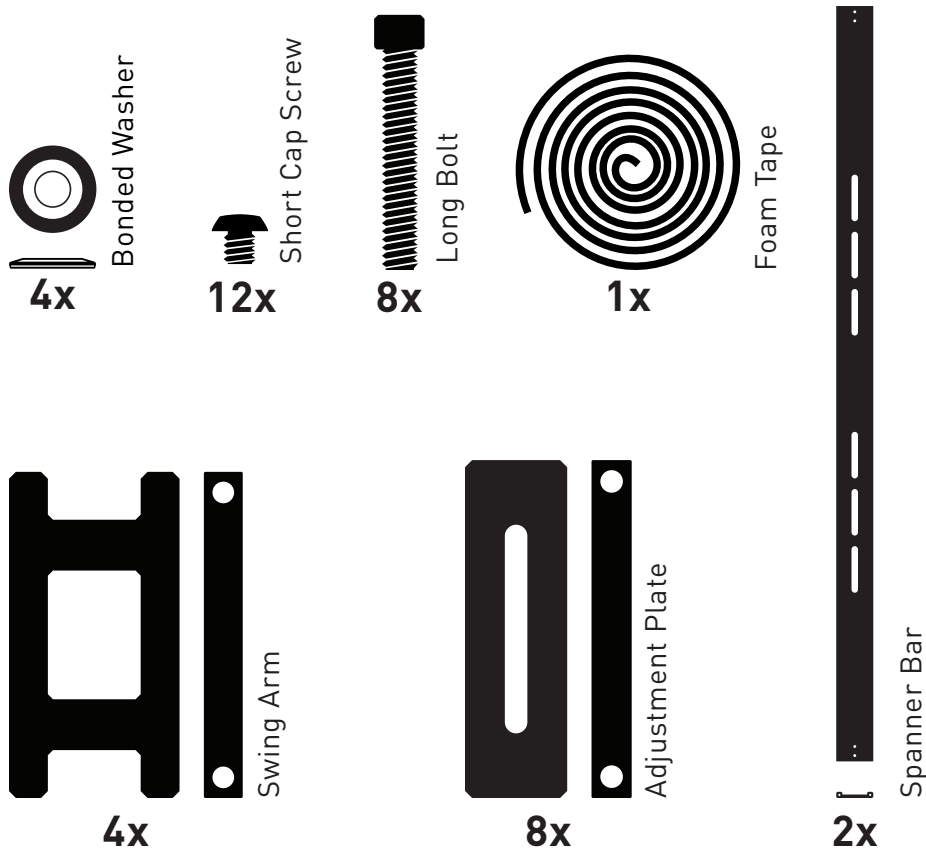

Bracket Hardware

*Not to scale

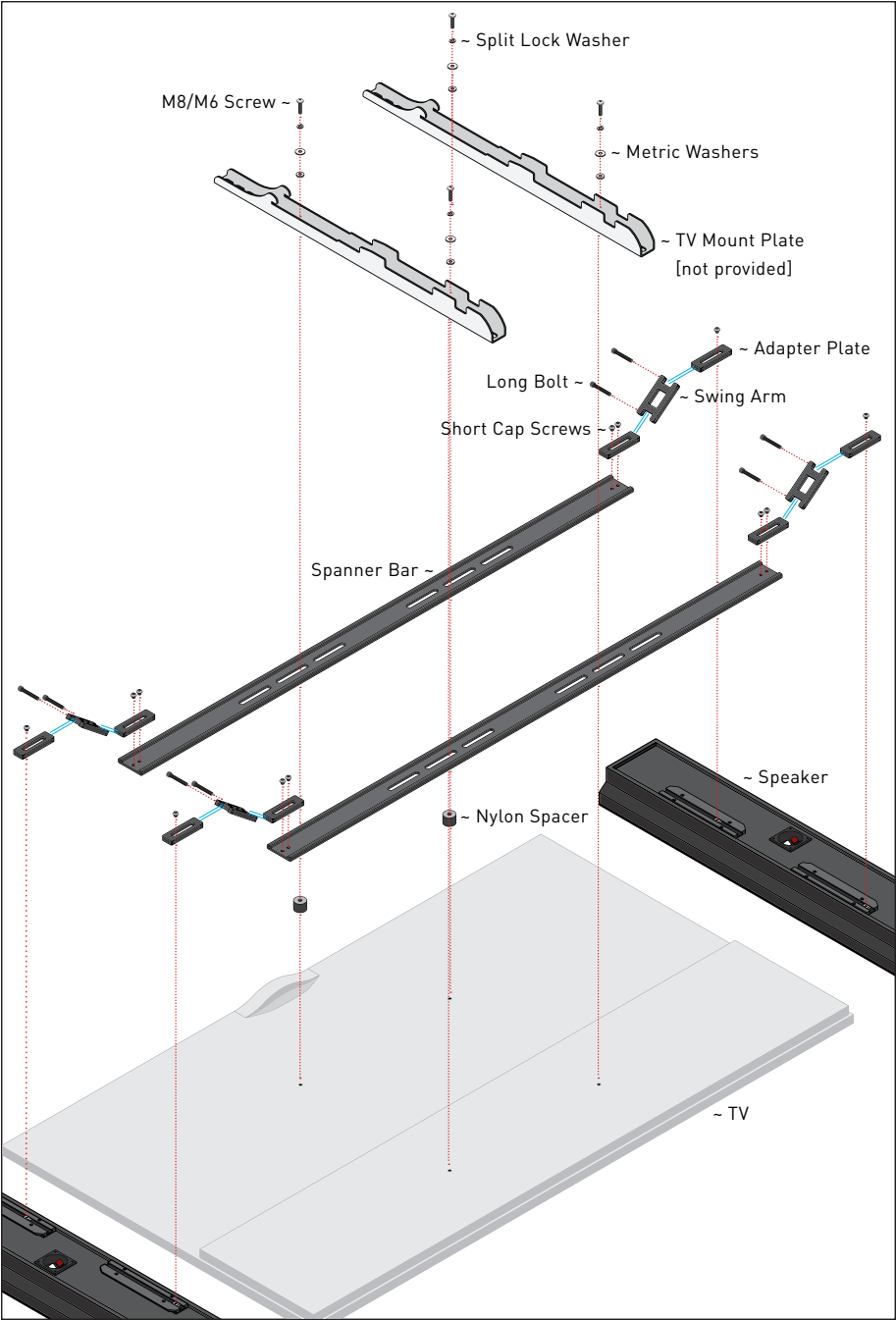

Parts List

*Not to scale

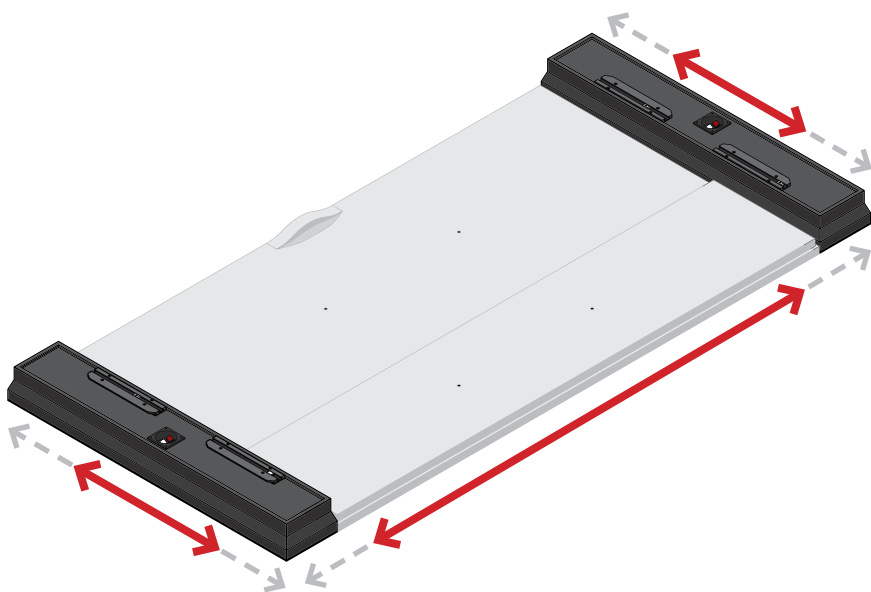

Align **Speakers** flush with **TV**

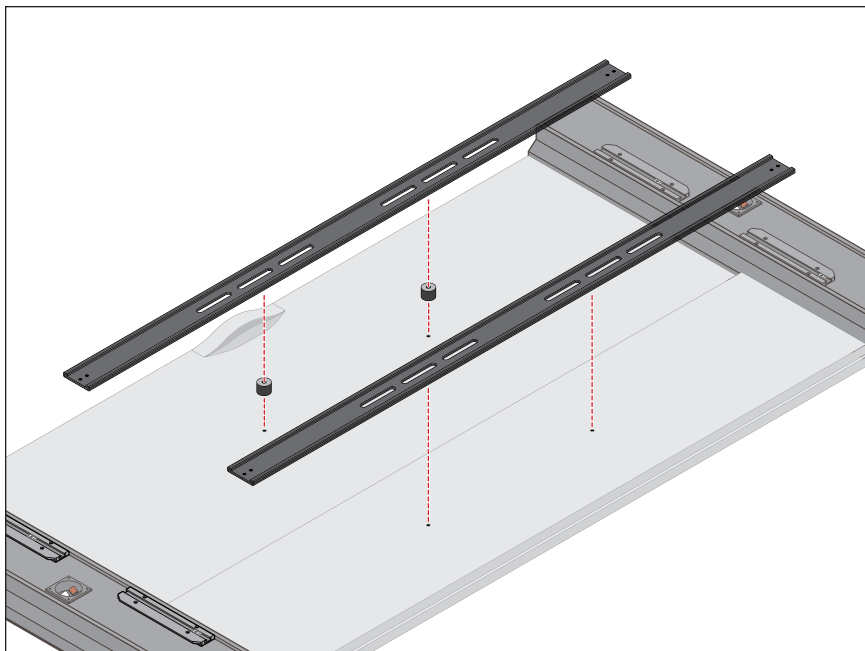

Align **Spanner Bars** with **TV Mount Holes**

Use Nylon Spacers as needed



Spanner Bars
2x



Nylon Spacer
4x/8x

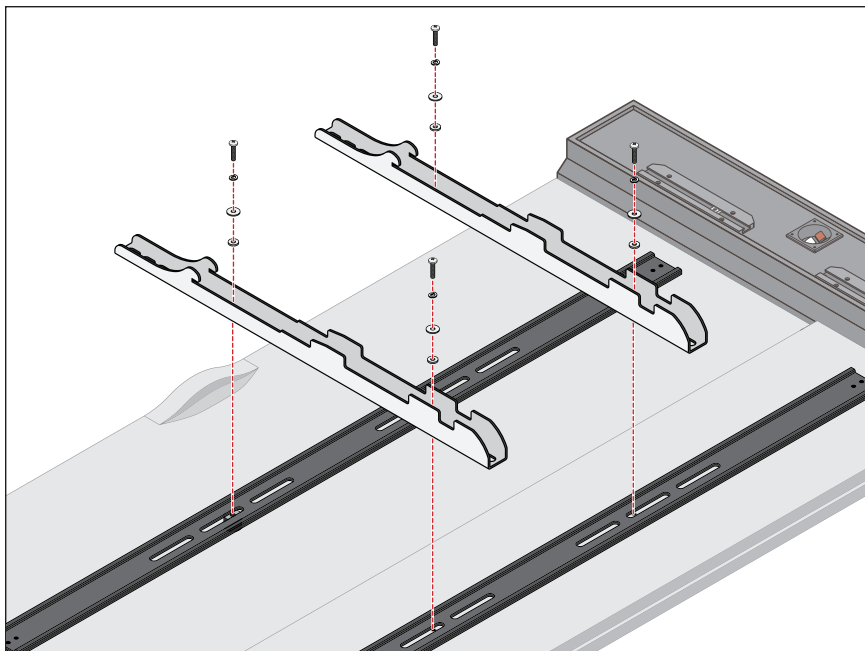

Overlay **TV Mount Rails*** and affix **Screws** with **Split Lock Washers**

*Mount Rails provided by TV mount manufacturer
Use Nylon Spacers as needed



Metric Washer

4x



Split Lock Washer

4x



Nylon Spacer

4x/8x

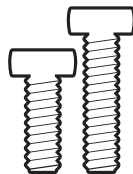

M8/M6 Screw

4x

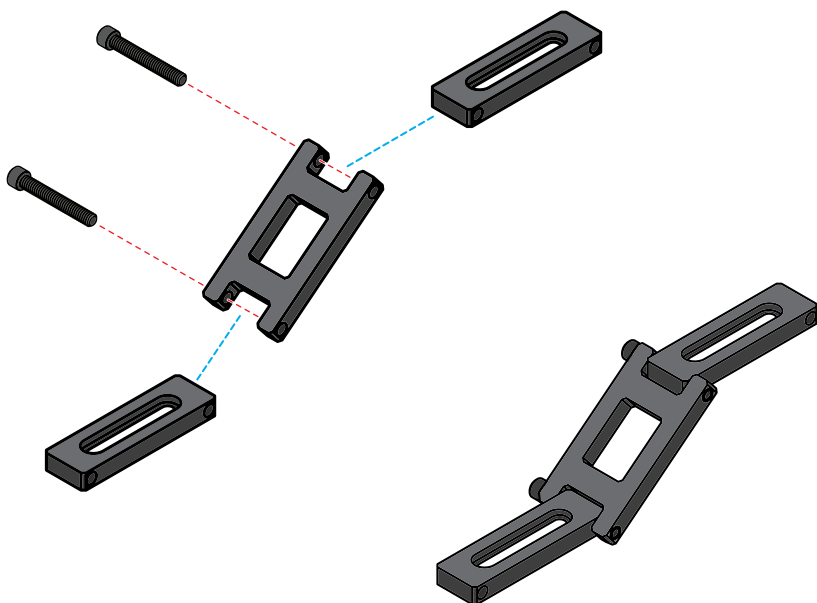

Connect **Adapter Plates** to **Swing Arms**
using **Long Bolts**

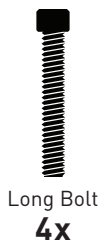



Locate **T-Slot*** rails on back of **Speaker**
and check for **Square Nuts**

*If T-Slot not attached, see pg.14 (T-Slot Mounting)

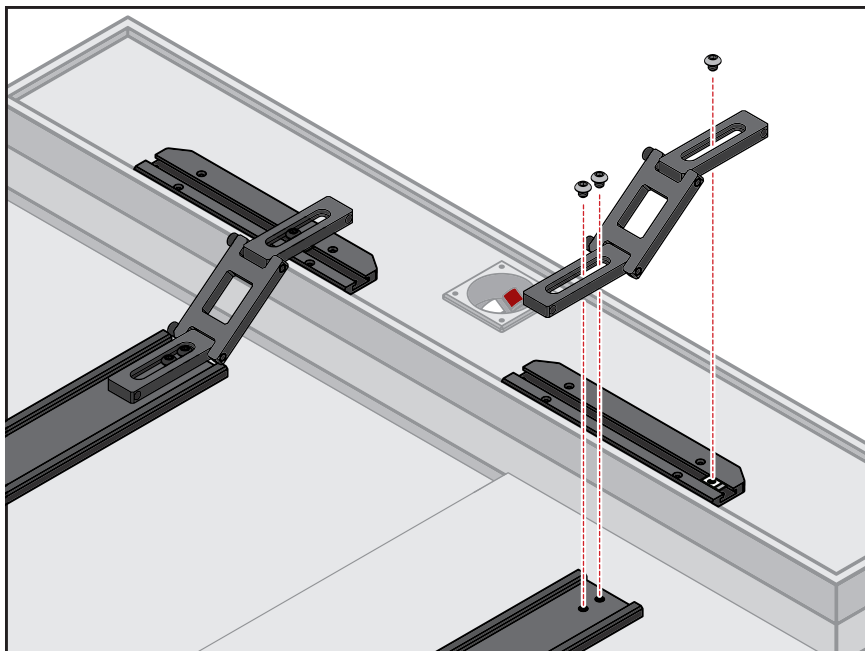

Connect **Adapter Plates** to **Spanner Bars** and **T-Slots** with **Short Cap Screws**

*Loosen **Long Bolts** on **Swing Arms** to allow adjustment



Short Cap Screw
12x

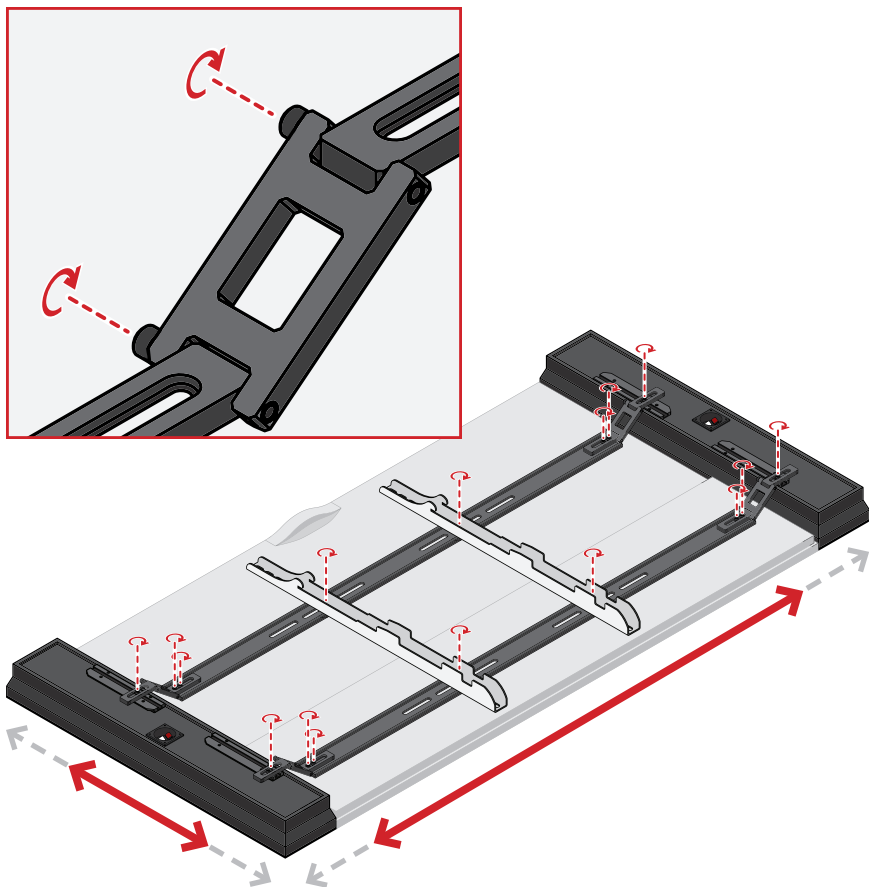

Tighten all **Screws & Connections**
and connect **Wiring** to **Speakers**

Ensure flush TV/Speaker alignment before tightening
***Long Bolts** require extra torque to secure **Swing Arms**



Carefully mount **TV/Speaker** assembly
and connect **Wiring** to **Speaker**

2 people suggested

T-Slot Mounting : Retrofitting Speakers

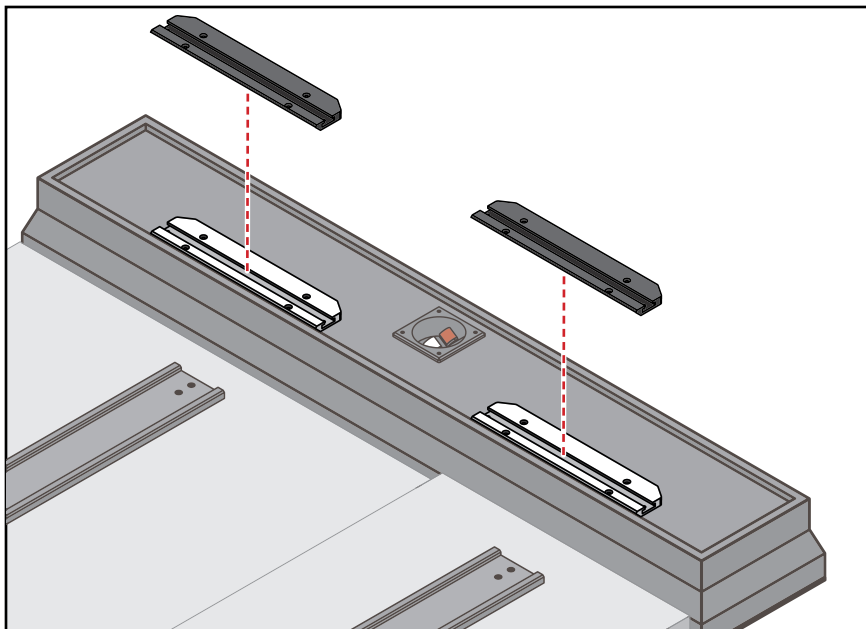

Align **Speaker** to **TV**
and place **T-Slots** flush* with inner side of
Speaker

***T-Slots** flush with bottom of speaker for **OMB**



T-Slots
2x

T-Slot Mounting : Retrofitting Speakers

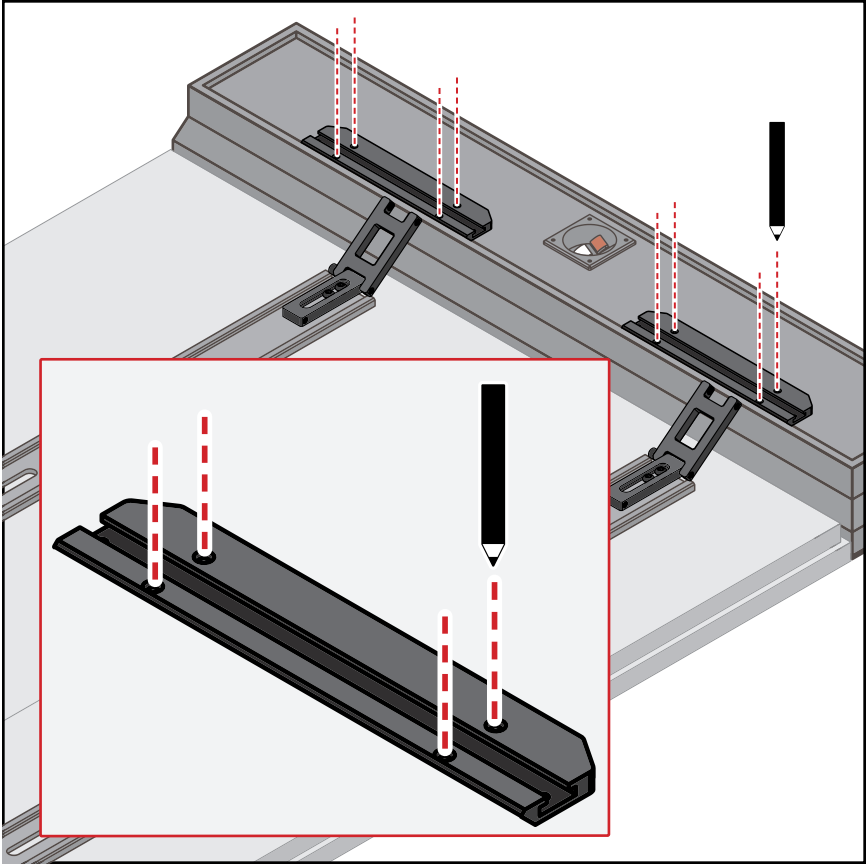

Align **T-Slots** with **Slide Rails/Swing Arms**
and mark **Pilot Holes***

*Mark locations may vary

T-Slot Mounting : Retrofitting Speakers

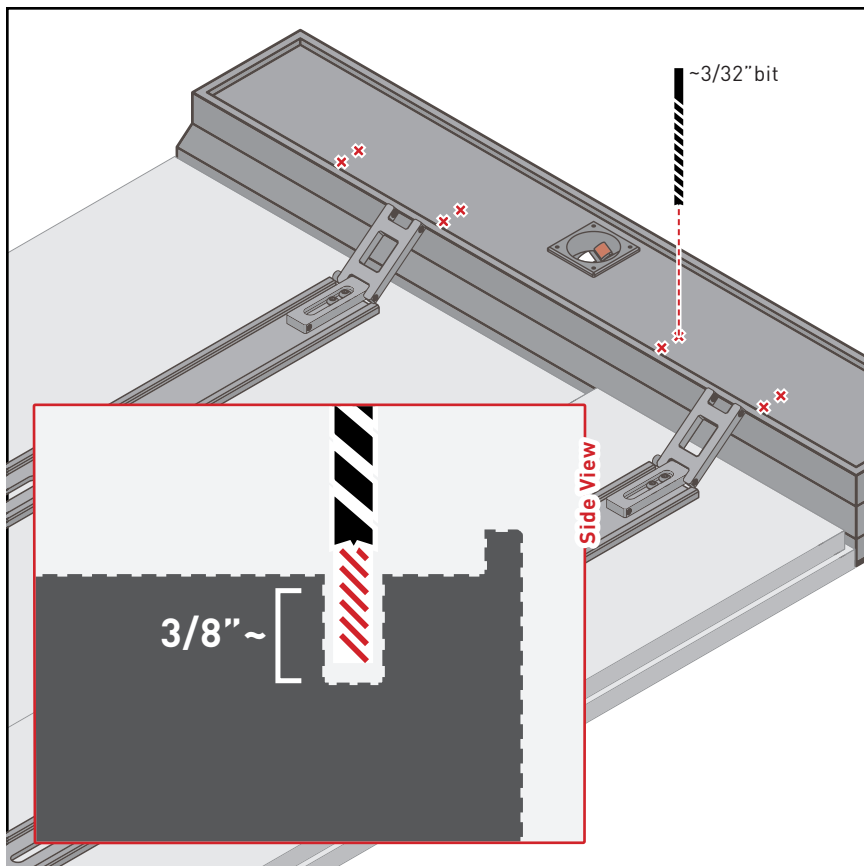

Remove **T-Slots** and carefully **Drill 3/8\"** deep **Pilot Holes** at mark locations

Use a **Drill Bit** no larger than **3/32\"**

T-Slot Mounting : Retrofitting Speakers

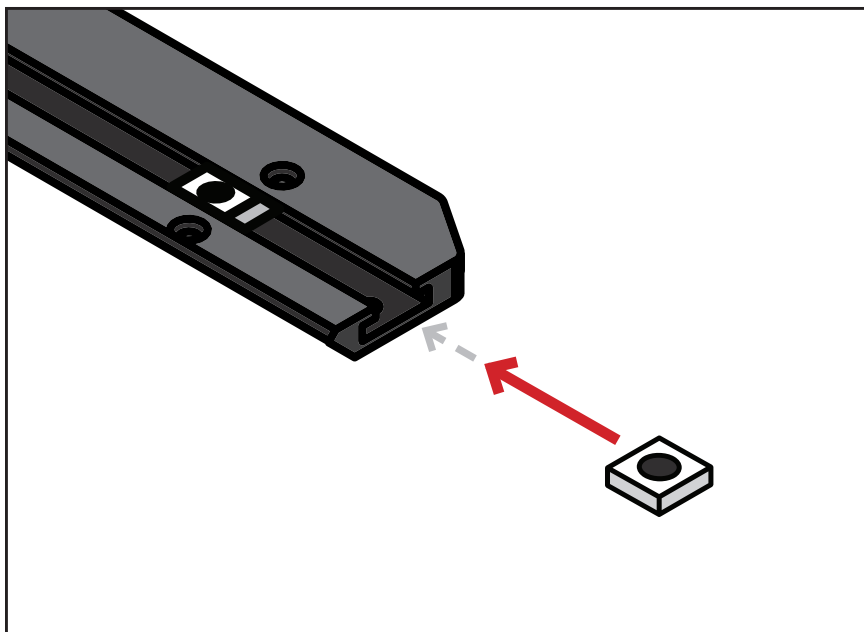

Slide **Square Nuts** in to **T-Slots**
and continue with mounting as directed

***Square Nuts** provided with T-Slot hardware



Square Nut
2x

T-Slot Mounting : Retrofitting Speakers

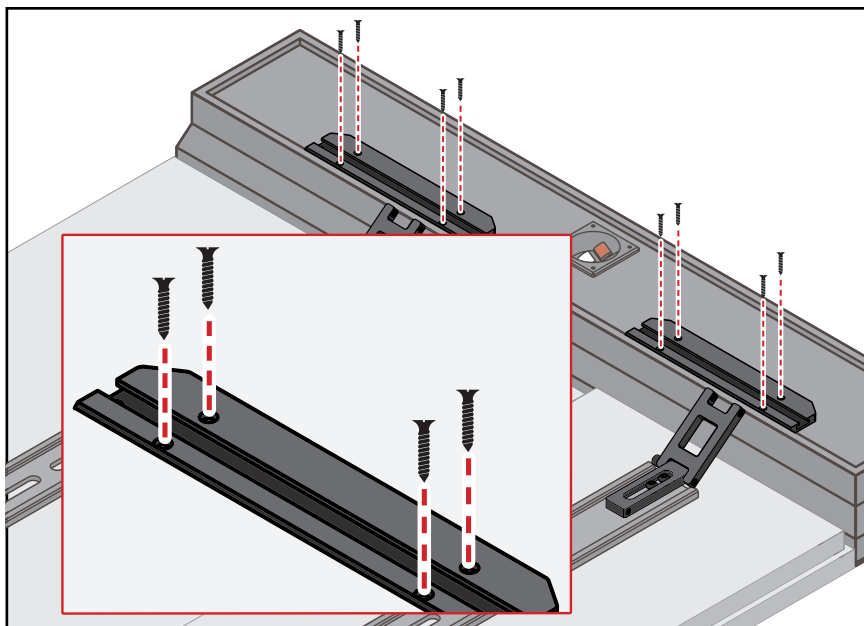

Attach **T-Slots** to Speaker with **Wood Screws**



Wood Screw
10x



Visit us online for product support, guides and videos
www.leonspeakers.com/support

Questions?

Call Customer Service

1.888.213.5015

Mon-Fri 8am-6pm EST



715 W. Ellsworth Road Ann Arbor, Michigan 48108 | 1.888.213.5015 | www.leonspeakers.com

Picture perfect sound.®